

Caratteristiche • Characteristics • Caractéristiques

- Cestello cassetto con fondo in nobilitato, guide ad estrazione totale e soft.
- Solid base pan drawer with full extension slides and soft closing.
- Panier de mélamine Fond de tiroir, diapositives extension complète de soft.

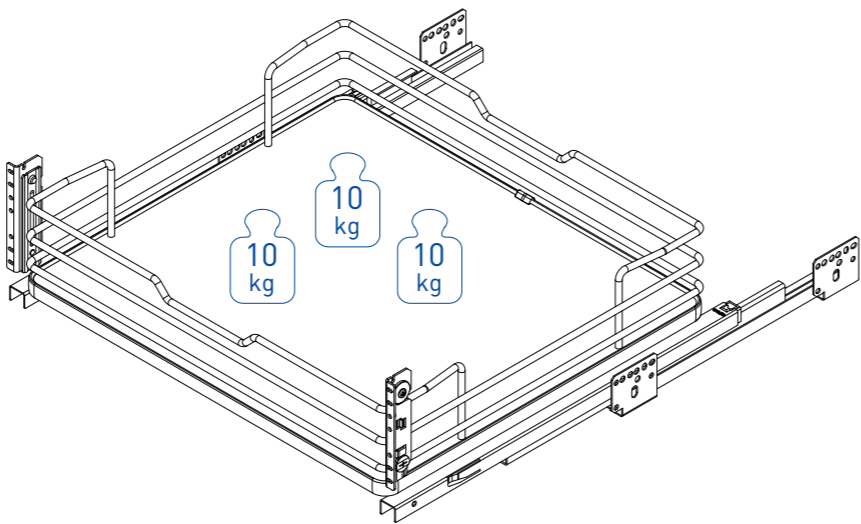

Componenti • Parts • Composants

- A.** Cestello Basket Panier
- B.** Set guide Slides kit Kit glissières
- C.** Staffe fissaggio antina Door brackets Pattes fixation porte
- D.** Set carter per guide Slides carter kit Kit carter glissières
- E.** Set spessori fianchi mobile da 18-20 mm Cabinet sides dividers kit 18-20 mm Kit séparateurs cotés meuble 18-20 mm
- F.** Set spessori fianchi mobile da 16-19 mm Cabinet sides dividers kit 16 - 19 mm Kit séparateurs cotés meuble 16 - 19 mm

Utensileria • Tools • Outils



Minuteria interna • Fittings • Ferrure



- N°14 Viti autofilettante 4x16 mm
- N°14 Self-tapping screws 4x16 mm
- N°14 Vis auto-taraudeuses 4x16 mm
- N°4 Eurovite 6.3x14mm
- N°4 Euro-screw 6.3x14mm
- N°4 Eurovis 6.3x14mm

**Montaggio 5 min
Assembly 5 min
Montage 5 min**

| | | |
|-------|-------|-------|
| Y | P.450 | P.500 |
| P MIN | 450 | 500 |

Y: profondità minima interno mobile
Y: minimum internal cabinet depth
Y: la profondeur minimale interne du meuble

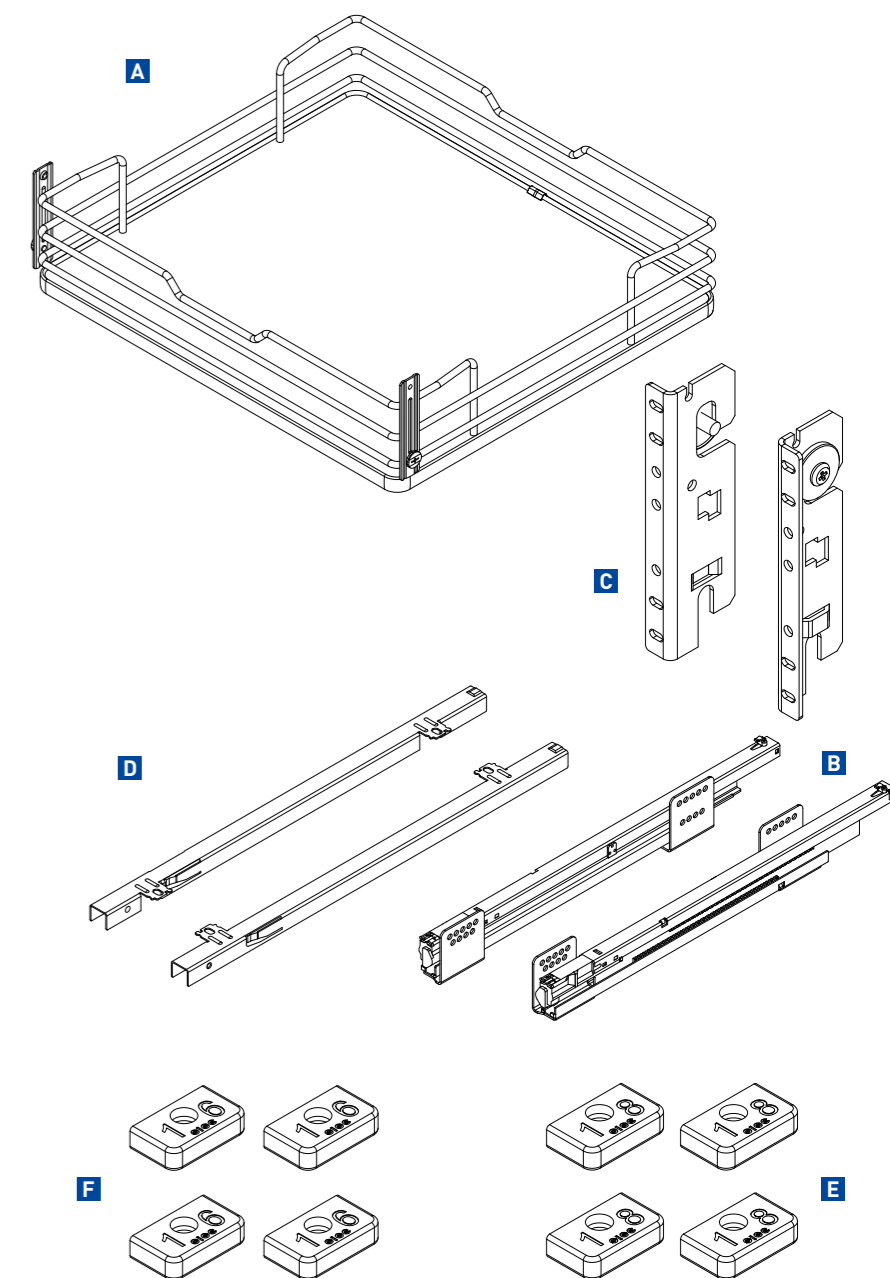
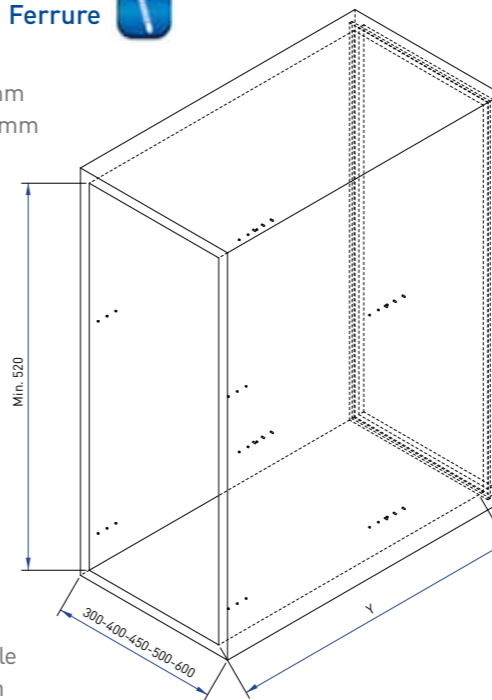

Made in Italy
Certified Integrated Systems
ISO 9001 • ISO 14001
OHSAS 18001 • SA 8000
www.sige-spa.it info@sige-spa.it
fax +39 071 90 90 804
tel +39 071 90 90 000 r.a.
60020 Polverigi (AN) ITALY
SIGE S.p.A.
ACCESSORI IN FILO METALLICO - WIRE PRODUCTS



La Sige Spa si riserva il diritto di apportare variazioni senza preavviso.
Sige Spa has the right to make changes on it without notice.
Sige Spa a le droit d'apporter des variations sans préavis.

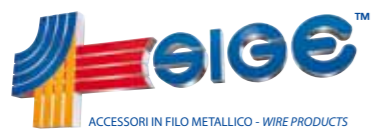

Art 116 i

Guide Sige
Sige slides
Glissières Sige

montaggio • assembly • montage

INFINITY

... per chi ha voglia di andare lontano ... to go further

Rev. 00/2012

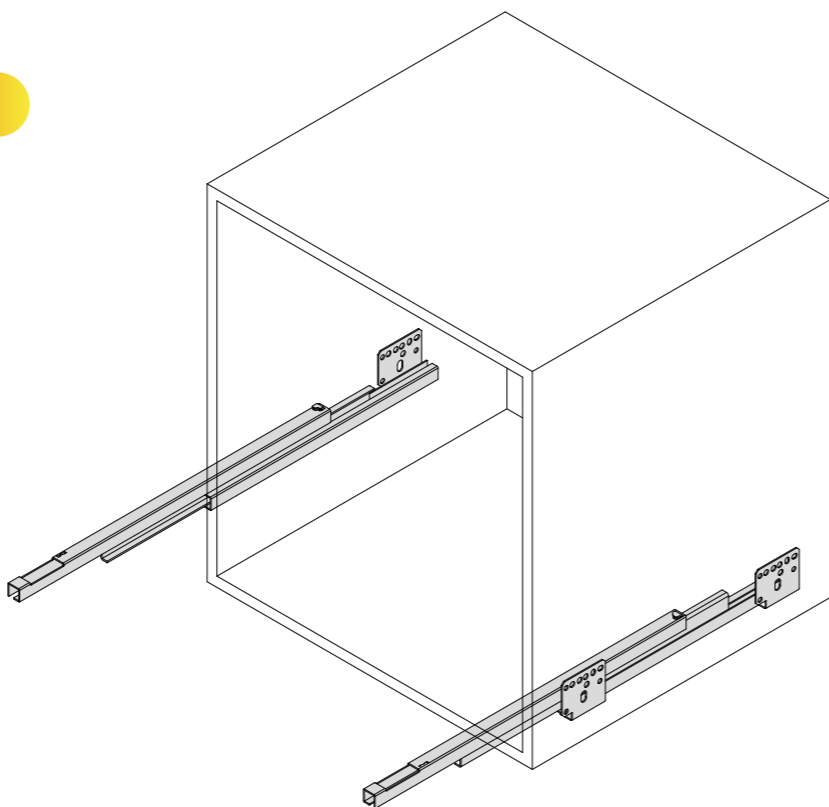

Posizionare le guide B rispettando le quote indicate ed avitarle con le apposite viti sui fianchi del mobile.
Place B slides respecting showed data and screw them on the cabinet's sides.
Positionez les glissières B en respectant les mesures indiquées et serrez les vis sur les côtés du meuble.

| | |
|--|-----|
| P.GUIDA Depth slides Profondeur des glissières | X |
| 450 | 288 |
| 500 | 320 |

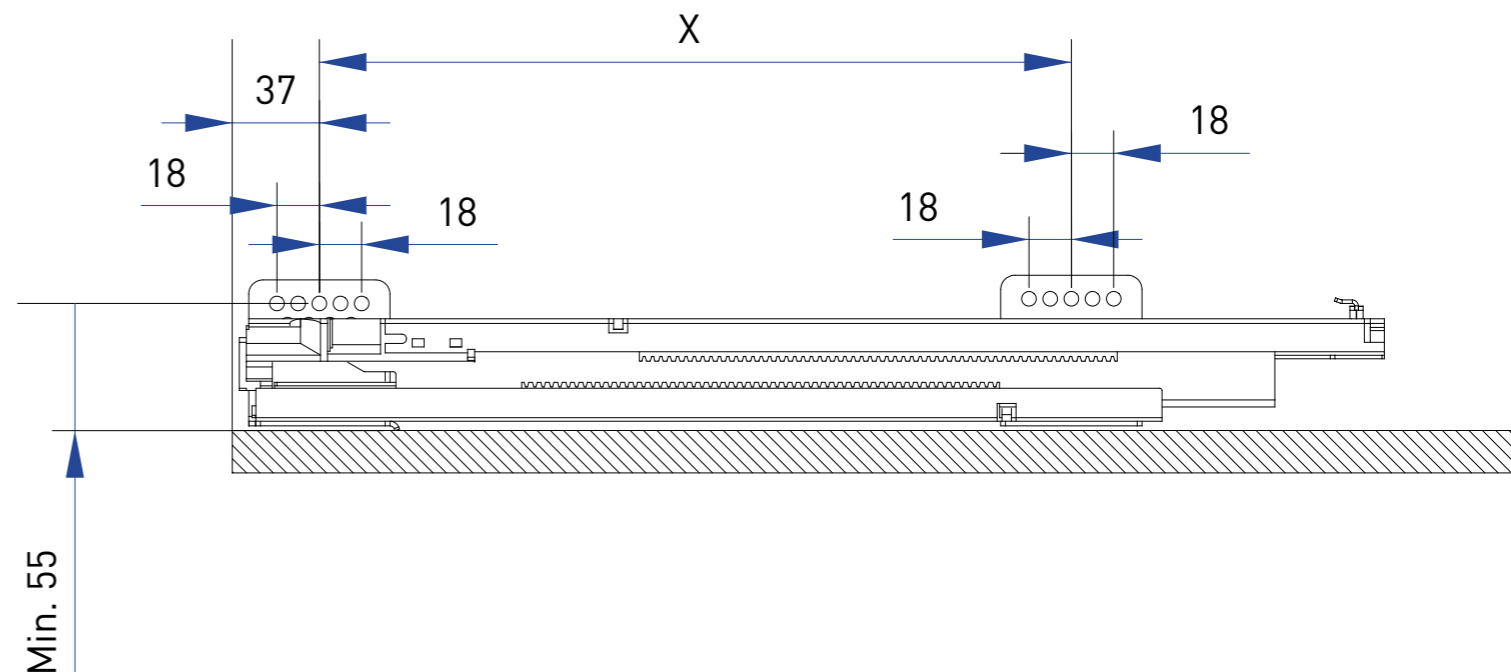

Avvitare le staffe C sull'antina rispettando le misure indicate.
Screw C brackets on the door respecting showed data.
Vissez les pattes C sur la porte en respectant les mesures indiquées.

Scegliere i particolari E o F a seconda del fianco mobile. Inserirli nel carter, ed avvitare il tutto tramite l'eurovite sul pianetto.
Choose E or F detail depending on the cabinet side. Insert into the carter and screw (Euro-screw) on the bottom.
Choisissez les particuliers E ou F selon le côté du meuble. Placez-les dans le carter, et serrez tout en utilisant l'eurovis sur le plateau.

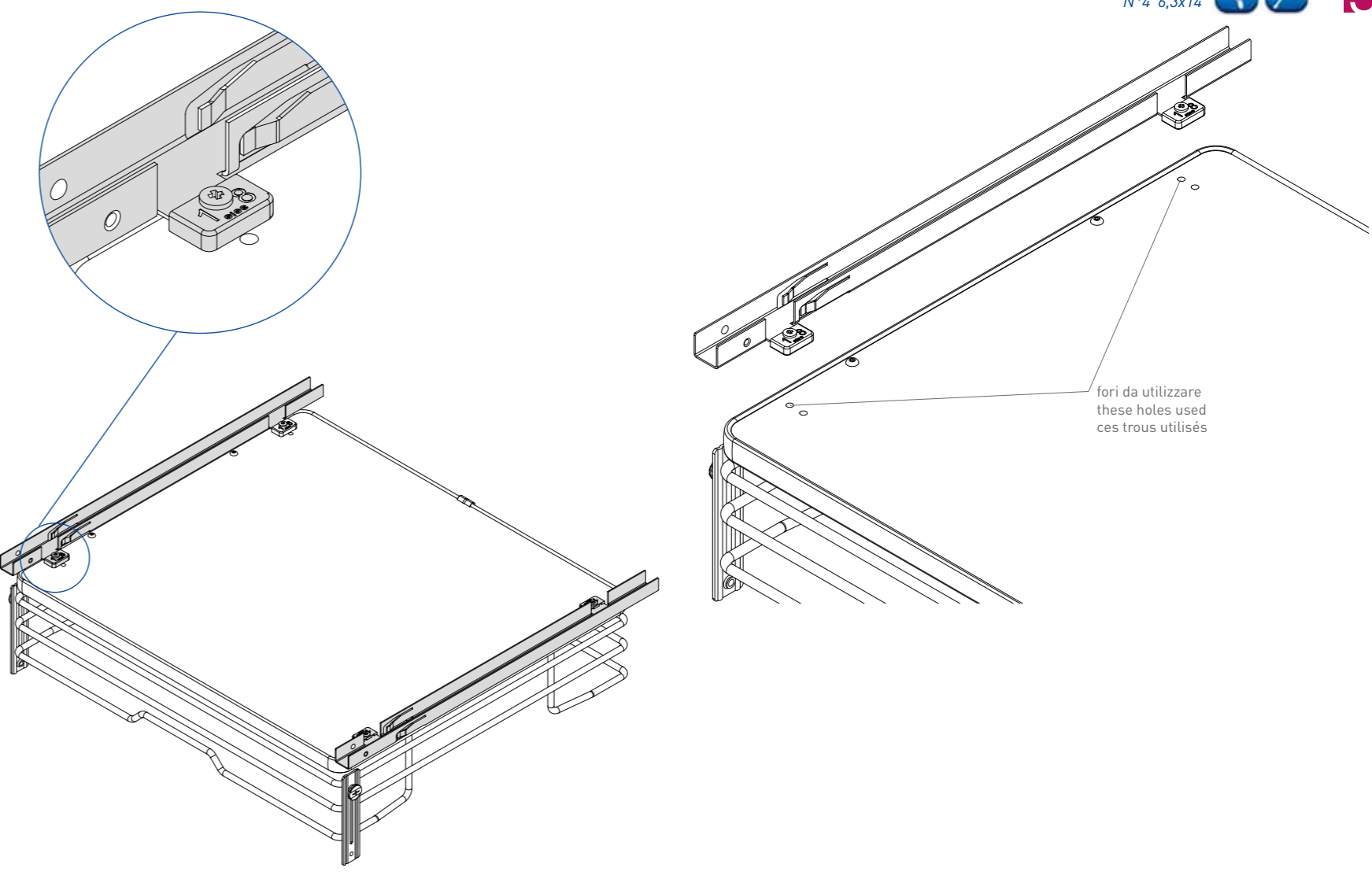
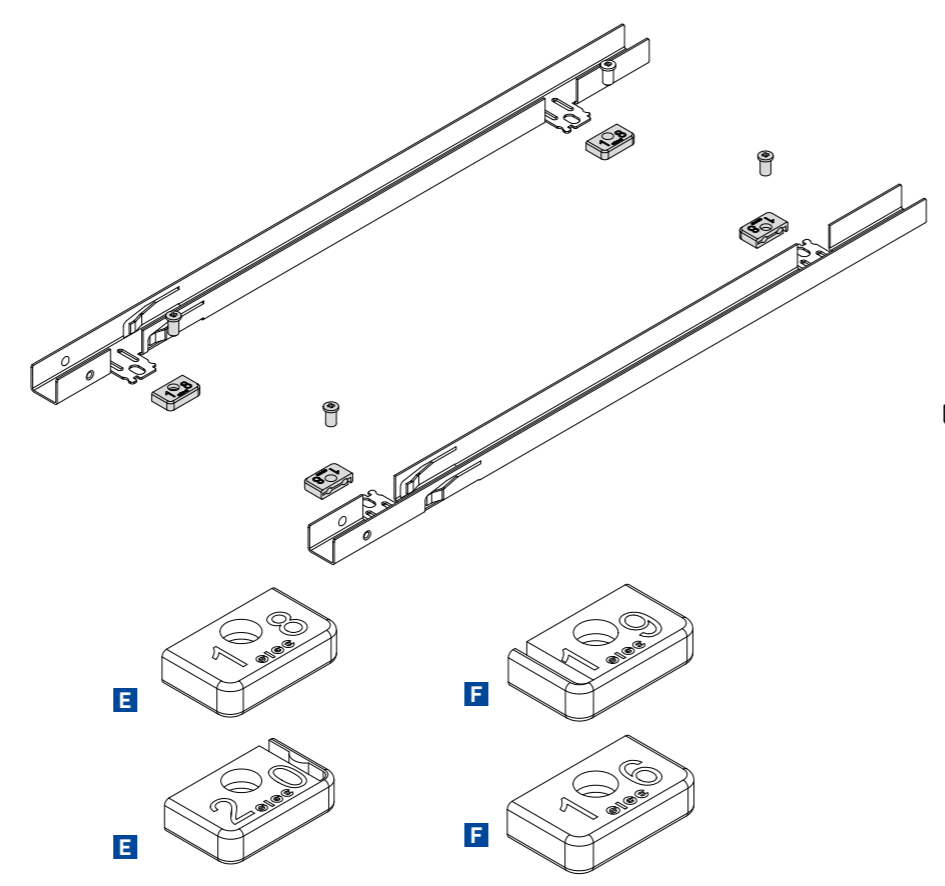
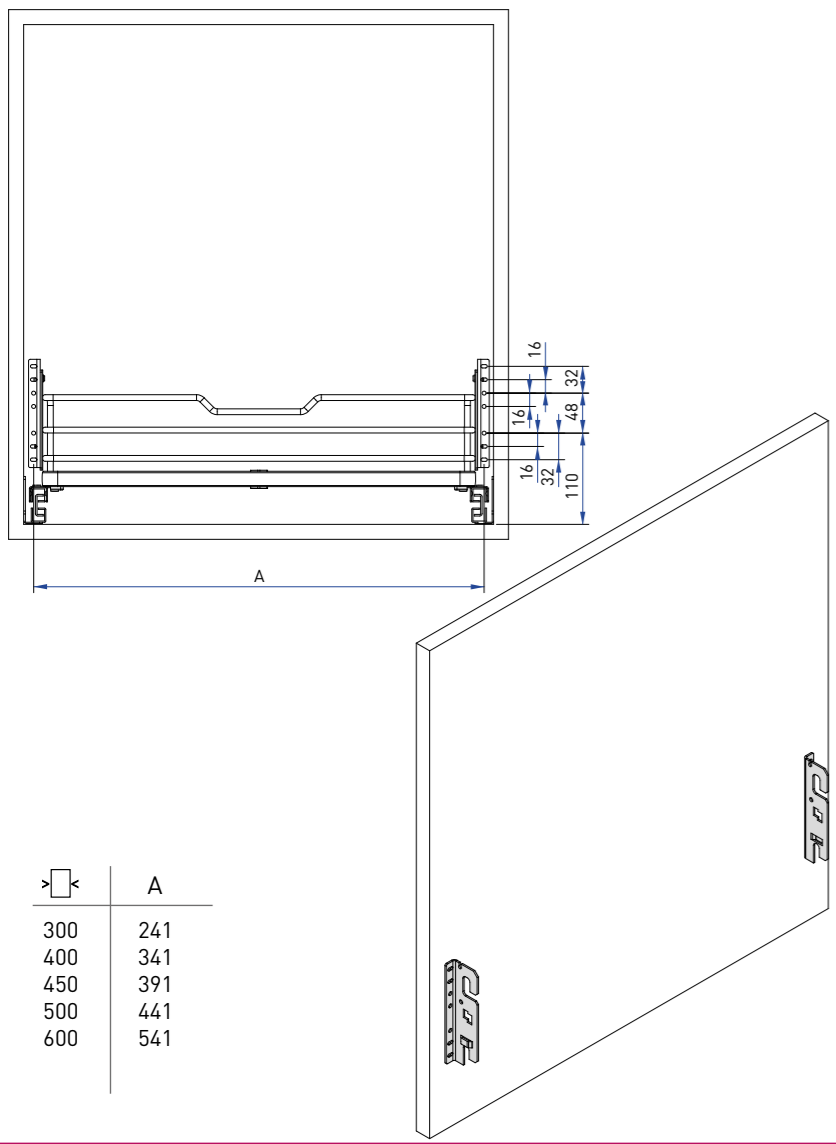

4

Montare il cesto A sulle guide B.
Fit basket A on slides B.
Montez le panier A sur les glissières B.

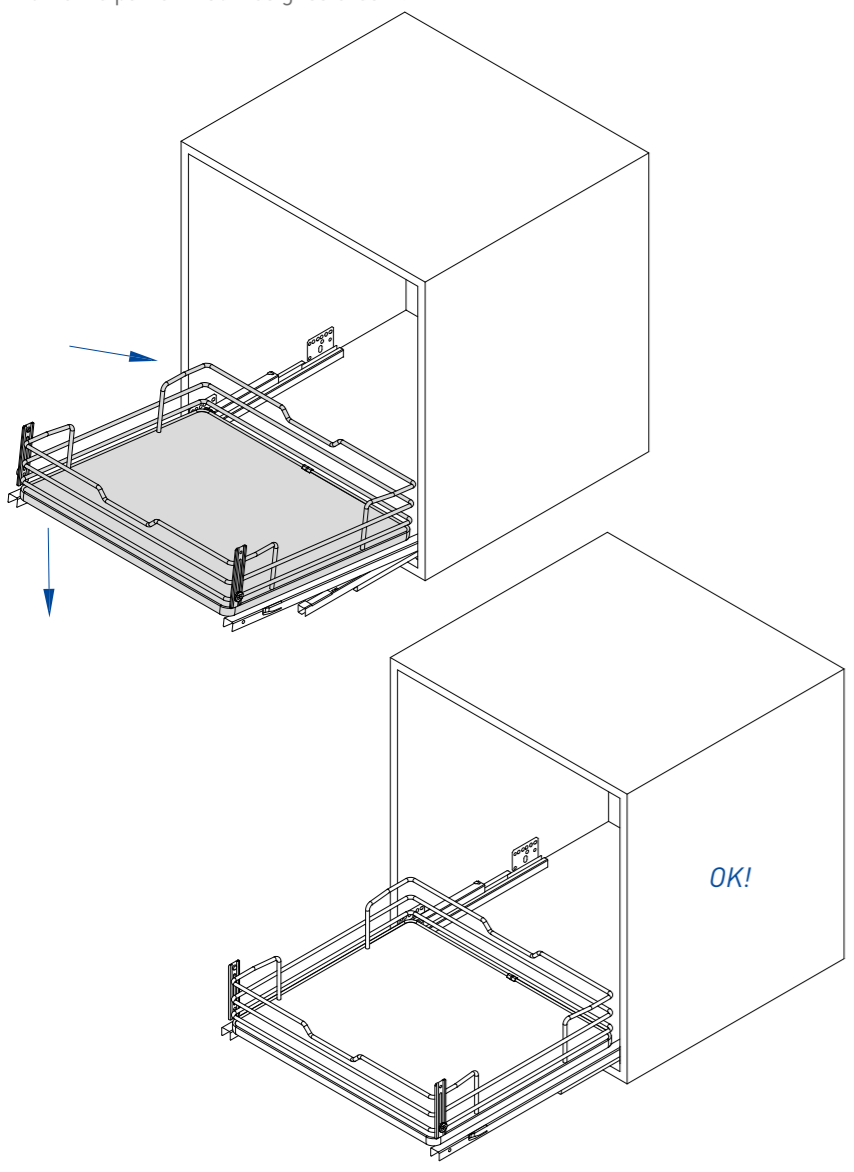

5

Montare l'antina sul cesto A.
Fix door on basket A.
Montez la porte sur le panier A.

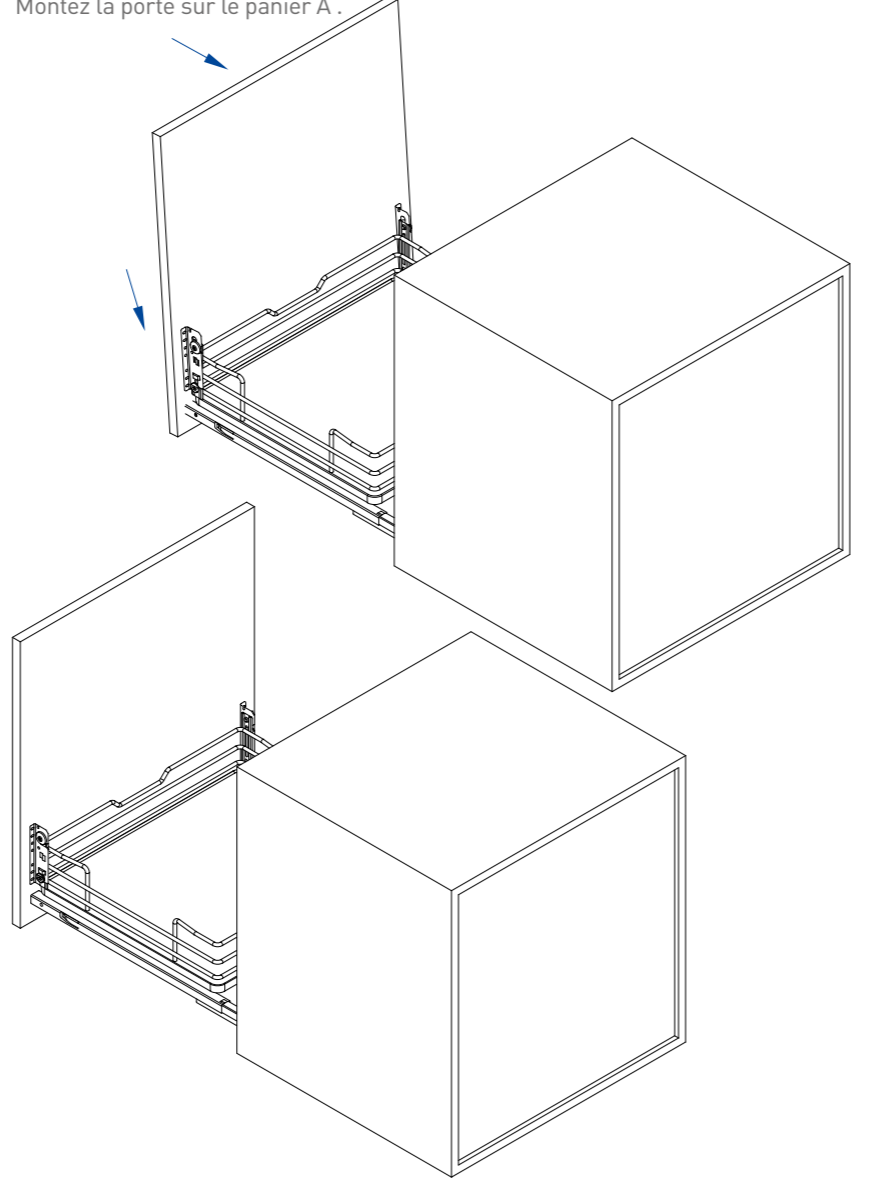

Effettuare le regolazioni.
Go on with the adjustments.
Faites les réglages.

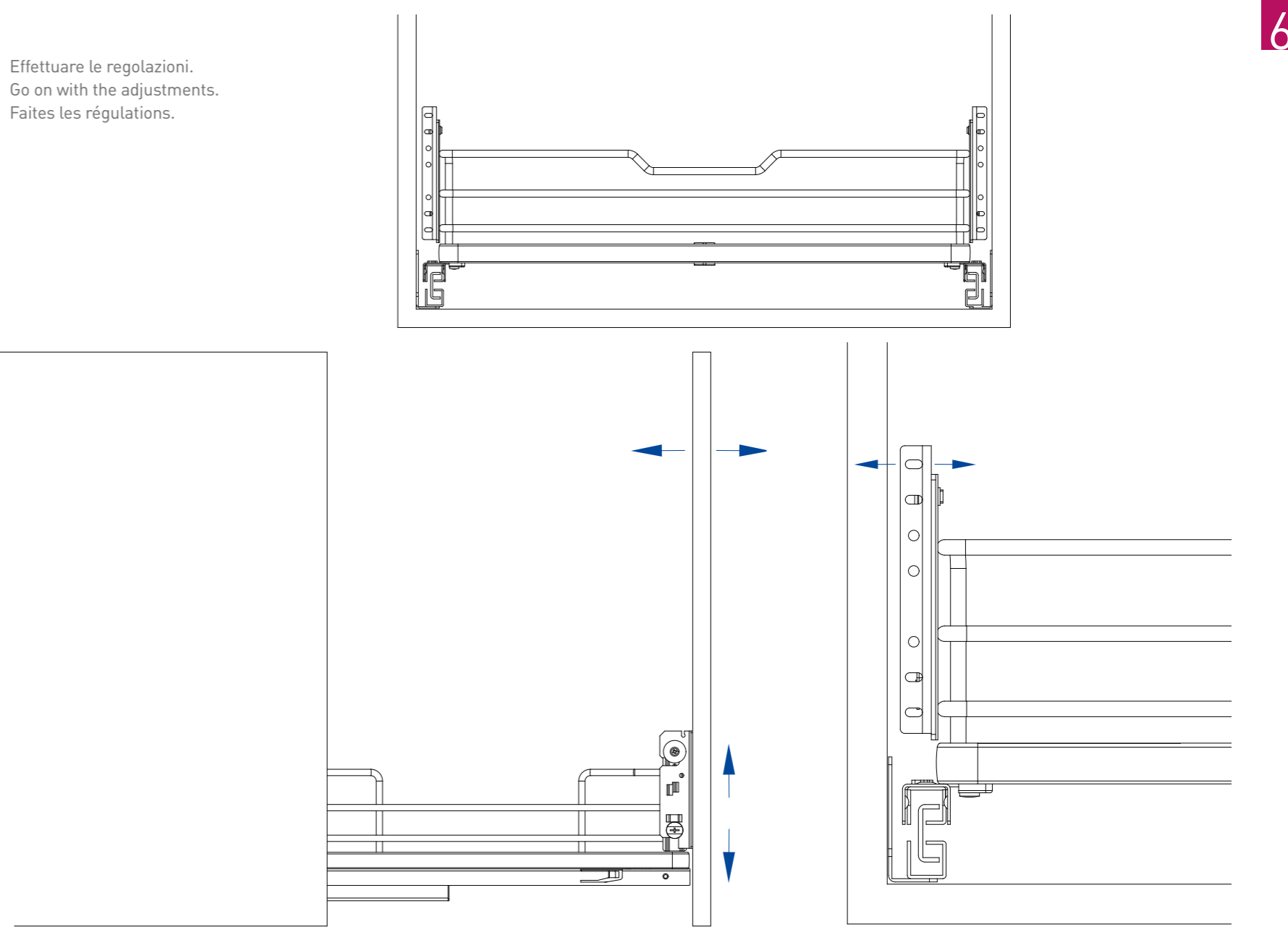

6